

## XIFC: Explosionproof Internally Flanged Control Enclosures

### FEATURES

- 13 standard sizes available
- One-piece, NEMA 4 water-tight gasket
- Premium, high-strength steel cover bolts
- Internal/external grounding provisions
- Cast-on mounting feet
- Tumbblast surface preparation for uniform, natural, aluminum finish

### DESIGN OPTIONS

- Blind-tapped holes for sub-panels
- Sub-panels – Available in galvanized steel (XSM) or aluminum (XSA)
- Non-removable piano-hinges
- Customer specified drilling and tapping
- Installation of operators and auxiliary devices
- Custom machining – milling, counter-boring, spot-facing, blind-tapped holes, etc
- Installation and wiring of internal terminal blocks and control components
- UL Listed NNNY populated/wired control panels
- Cast-on company logos
- Multiple coating options for additional corrosion resistance
- Special mounting provisions

### MATERIAL

- Enclosures cast from proprietary 359 aluminum alloy – contains less than 3/10 of 1% copper (.003)
- Standard steel metric cover bolts are zinc-plated and coated
- Nitrile "O"-rings
- XSM panels are #12 gauge galvanized steel (.108" thick)
- XSA panels are #10 gauge aluminum (.100 thick)

### Certifications

Class I, Divisions 1 and 2, Groups C and D  
 Class II, Divisions 1 and 2, Groups E, F, and G  
 Class III  
 NEMA Type 4, 7, and 9

UL1203/CSA C22.2 No. 25 & 30  
 UL1203/CSA C22.2 No. 25 & 30  
 UL1203/CSA C22.2 No. 25 & 30  
 UL50



# XIFCX: Flameproof Internally Flanged Control Enclosures

## FEATURES

- 13 standard sizes available
- Premium, high-strength steel, metric cover bolts
- Internal/external grounding provisions
- Cast-on mounting feet
- Tumbast surface preparation for uniform, natural, aluminum finish

## DESIGN OPTIONS

- Blind-tapped holes for sub-panels
- Sub-panels – Available in galvanized steel (XSM) or aluminum (XSA)
- Non-removable piano-hinges
- Customer specified drilling and tapping
- Installation of operators and auxiliary devices
- Custom machining – milling, counter-boring, spot-facing, blind-tapped holes, etc
- Installation and wiring of internal terminal blocks and control components
- Cast-on company logos
- Multiple coating options for additional corrosion resistance
- Special mounting provisions

## MATERIAL

- Enclosures cast from proprietary 359 aluminum alloy – contains less than 3/10 of 1% copper (.003)
- Standard steel cover bolts are zinc-plated and coated
- Nitrile "O"-rings
- XSM panels are #12 gauge galvanized steel (.108" thick)
- XSA panels are #10 gauge aluminum (.100 thick)

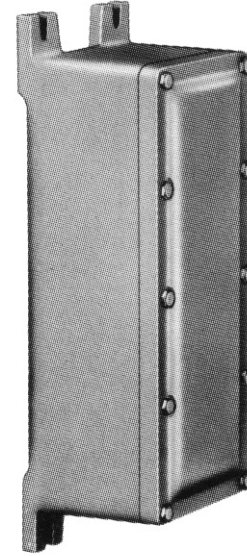

## Certifications

Class I, Divisions 1 and 2, Groups C and D  
 Class II, Divisions 1 and 2, Groups E, F, and G  
 Class III  
 NEMA Type 7 and 9  
 Class I, Zone 1, AEx d IIB  
 Class I, Zone 1, Ex d IIB  
 0539 II 2G  
 IP40

UL1203/CSA C22.2 No. 25 & 30  
 UL1203/CSA C22.2 No. 25 & 30  
 UL1203/CSA C22.2 No. 25 & 30  
 UL50  
 IEC 60079-1  
 ATEX Directive 94/9/EC  
 IEC 60529



## Customer Design Sheet

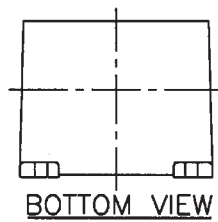
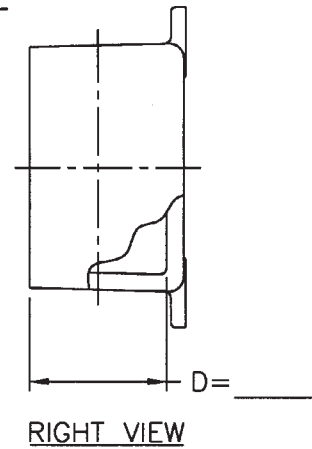
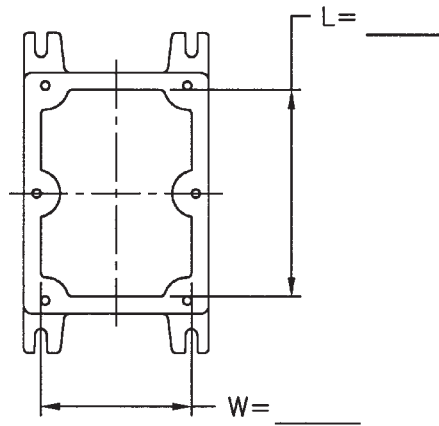
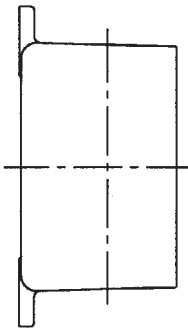
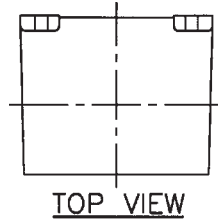

BOX LAYOUT

CAT # XIF (C)(X) \_\_\_\_\_

N4 O RING (XIFC Only)

MOUNTING PAN

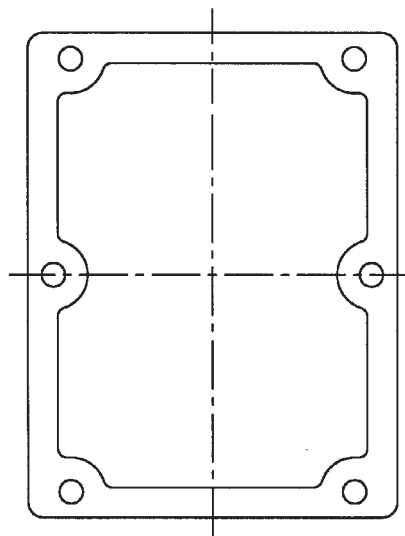

# XIFC/X SERIES

EXPLOSIONPROOF  
XIFC/X Enclosures

## XIFC: Explosionproof Internally Flanged Control Enclosures

## XIFCX: Flameproof Internally Flanged Control Enclosures

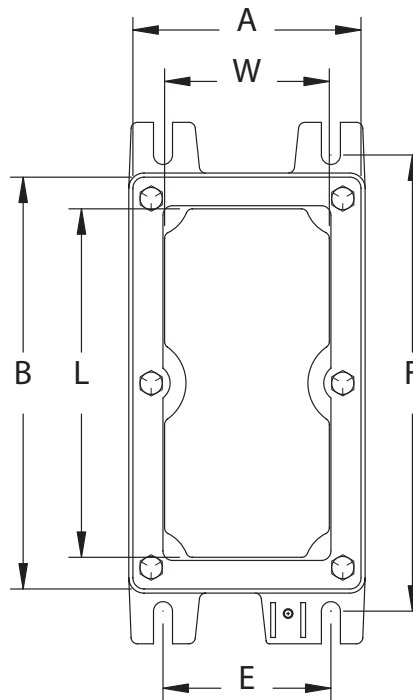
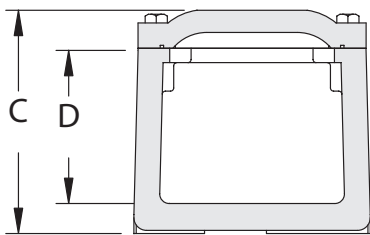

XIFC/XIFCX Catalog #	Inside Nom. Dim.			Overall Dimensions			Mtg Lug		Mtg Bolt Size	Ship Weight (lbs)	Pan Catalog #		Panel Dim.	
	W	L	D	A	B	C	E	F			Steel	Alum.	W	L
XIFC/X-030303	3 5/16	3 3/16	3 3/16	4 1/2	4 1/2	4 5/16	3 1/4	5 1/2	5/16	5	XSM0303	XSA0303	3	3
XIFC/X-030603	3 1/4	5 3/4	3	4 1/2	7 1/16	4 1/4	3 1/4	8	5/16	6 1/2	XSM0306	XSA0306	3	5 1/2
XIFC/X-030703	3 1/4	6 7/8	3	4 1/2	8 1/8	4 5/16	3 5/16	9	5/16	7 1/2	XSM0307	XSA0307	3	6 1/2
XIFC/X-030903	3 11/32	8 15/16	3	4 1/2	10 1/16	4 5/16	3 1/4	11	5/16	9 1/2	XSM0309	XSA0309	3	8 1/2
XIFC/X-031103	3 1/4	10 15/16	3	4 1/2	12	4 5/16	3 1/4	13	5/16	11	XSM0311	XSA0311	3	10 1/2
XIFC/X-031303	3 1/4	12 13/16	3	4 1/2	14 1/16	4 5/16	3 1/4	15	5/16	11 1/2	XSM0313	XSA0313	3	12 1/2
XIFC/X-031503	3 1/4	14 3/4	3 1/16	4 1/2	16	4 5/16	3 1/4	17	5/16	13	XSM0315	XSA0315	3	14 1/2
XIFC/X-040604	4 1/8	5 7/8	4	5 3/8	7	5 5/16	4 3/8	8 1/4	5/16	8 1/2	XSM0406	XSA0406	3 7/8	5 1/2
XIFC/X-041204	4 1/4	11 13/16	4	5 1/2	13 3/8	5 5/16	4 3/8	14 1/4	5/16	15 1/2	XSM0412	XSA0412	3 7/8	11 1/2
XIFC/X-060606	5 1/2	5 1/2	6	7	7	7 3/8	5 1/2	8 1/2	3/8	14	XSM0606	XSA0606	5 1/2	5 1/2
XIFC/X-060608	5 1/4	5 1/2	8	7	7	9 3/8	5 1/2	8 1/2	3/8	17 1/2	XSM0606	XSA0606	5 1/2	5 1/2
XIFC/X-061206	5 1/4	11 1/8	6	7 1/4	13 1/2	7 5/8	5 1/2	15	3/8	28	XSM0612	XSA0612	5 1/2	11 1/2
XIFC/X-070704	6 7/8	6 7/8	4	7 15/16	7 15/16	5 5/16	6 5/8	9 3/8	3/8	13	XSM0707	XSA0707	6 1/2	6 1/2